

43-051, 43-052, 43-061, 43-071

Prefixes: 08, 80, 88, X, XX

Suffixes: 48, 60, 61, 62, 63, 65, 67, 68

ITEM NO.	DESCRIPTION	UN-FINISHED	CHROME
1	"C" INDEX BUTTON	94-254	
	"H" INDEX BUTTON	94-253	
2	HANDLE SCREW	90-700	
3	STANDARD HANDLE S/A, HOT		97-915
	STANDARD HANDLE S/A, COLD		97-916
	STANDARD HANDLE PACK, HOT & COLD W/ KNOB		60-002
4	VALVE ESCUTCHEON (BRASS)		91-464
	VALVE ESCUTCHEON (ZINC)		91-462
5	CELCON WASHER	90-331	
6	HOT COMPRESSION CARTRIDGE	98-688	
	COLD COMPRESSION CARTRIDGE	98-689	
7	LOCKNUT	91-022	
8	BRASS WASHER 1 1/8" DIA.	93-465	
9	RUBBER WASHER 1 1/8" DIA.	93-466	
10	RUBBER WASHER 1 1/4" DIA.	93-464	
11	BRASS WASHER 1 1/4" DIA.	93-463	
12	LOCKNUT	91-580	
13	SUPPLY NUT S/A (QTY 2)	97-819	
14	HOT COMPRESSION END VALVE S/A	98-228	
	COLD COMPRESSION END VALVE S/A	98-226	
15	MALE AERATOR W/ FLOW RESTRICTOR		91-572
16	SHANK WASHER	91-028	
17	SHANK NUT	91-007	
18	SPOUT ASSY.		98-335
19	1/4" NOM. COPPER TUBE X 5"	90-910	
20	TEE S/A	98-232	
21	BALL, ROD, NUT, & CLEVIS S/A	97-733	
22	PACKING FOR LAVATORY DRAIN	90-832	
23	FLANGE FOR CAST POP-UP DRAIN		90-731
24	POP-UP PLUNGER / O-RING S/A		97-731
25	O-RING	90-741	
26	CAST POP-UP LAVATORY DRAIN S/A		97-773
27	CAST POP-UP DRAIN KIT (INCLUDES ITEMS 26, 28, 30)		43-973
28	POP-UP KNOB & ROD S/A		97-722
29	POP-UP KNOB		95-183
30	POP-UP EXTENSION S/A		97-340
31	50 / 50 POP-UP DRAIN KIT (INCLUDES ITEM 28, 30, 32)		43-969
32	50 / 50 POP-UP LAVATORY DRAIN S/A		97-769
33	GRID STRAINER LAVATORY DRAIN ASSY.		43-970
34	BRASS SEAT	91-015	
35	FERRULES & FERRULE NUTS (QTY 4 EA.)	97-803	

**Plumbing Parts
Depot**
610-495-8790
www.ppd1.biz

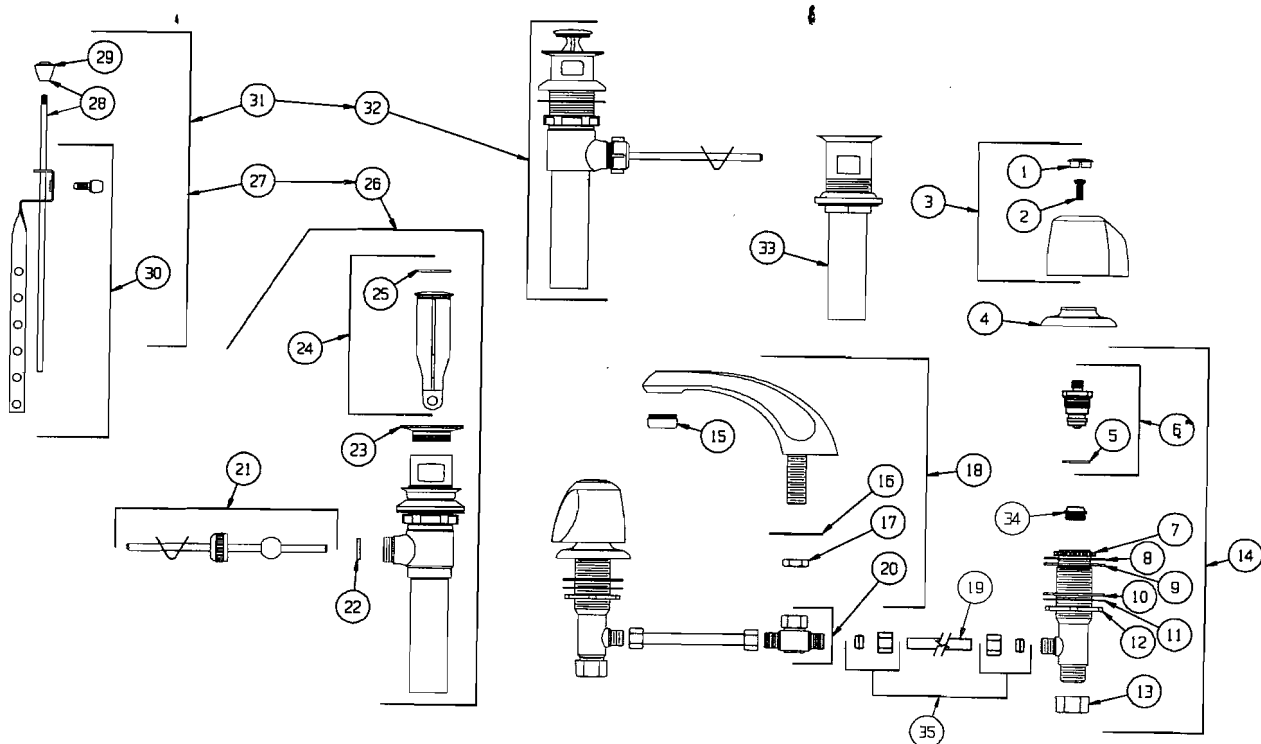

See the Index for a Description of Prefixes & Suffixes