

28-190, 28-192, 28-193, 28-196, 28-197, 28-198 (for combinations: 21-112, 21-122, 21-132)

Prefixes: See list price sheet

Suffixes: See list price sheet

ITEM NO.	PART NO.	DESCRIPTION	1.6 gpf (6 Lpf)		3.5 gpf (13.3 Lpf)	
			28-193 28-196	28-197 insul 28-198 insul	28-190	28-192 insul
1	99-532	6" FLUSHVALVE FOR MIRAGE TOILET	1	1		
2	99-524	TIME RATED FLAPPER WITH STRAP (USE ORANGE BAFFLE)	1	1		
3	99-599	TANK BOLT	2	2	2	2
4	99-580	RUBBER WASHER	4	4	4	4
5	99-591	RUBBER BEVELED GASKET (GREEN)	1	1	1	1
6	99-576	5/16" METAL WASHER	2	2	2	2
7	99-589	HEX NUT	2	2	2	2
8	99-577	PLASTIC WING NUT	2	2	2	2
9	99-287	PLASTIC BOLT CAP & WASHER ASSEMBLY (FOR BOWL)	2	2	2	2
10	99-399	COUPLING NUT FOR BALLCOCK	1	1	1	1
11	99-305	9 1/4" BALLCOCK - 13.5% REFILL (orange screw)	1	1		
12	99-585	LEFT HAND CHROME PLATED PLASTIC TANK LEVER ASSEMBLY	1	1	1	1
	99-585-RH	RIGHT HAND CHROME PLATED PLASTIC TANK LEVER ASSEMBLY			Optional	
	99-586	LEFT HAND WHITE PLASTIC TANK LEVER ASSEMBLY			Optional	
	99-586-RH	RIGHT HAND WHITE PLASTIC TANK LEVER ASSEMBLY			Optional	
13	99-536	UNIT BAG (WHITE)	1	1	1	1
14	99-531	7-1/4" COUNTERBALANCE FLAPPER FLUSH VALVE			1	1
15	99-529	COUNTERBALANCE FLAPPER/WASHER ASSEMBLY			1	1
16	99-508	8-1/2" FLOAT ROD			1	1
17	99-598	FLOAT BALL			1	1
18	99-394	REPAIR KIT (INCLUDES PISTON ASSEMBLY, SEALER RING & 3 ASSEMBLY SCREWS)			1	1
19	99-357	10-1/4" ANTI-SIPHON BALLCOCK ASSEMBLY - 24% REFILL (yellow screw)			1	1

* Insulated Liner for 28-197 & 28-192 cannot be purchased separately.

28-193/196/197/198
(1.6 gpf)

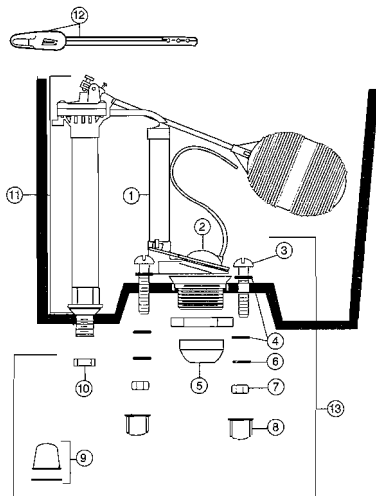

28-190/192
(3.5 gpf)

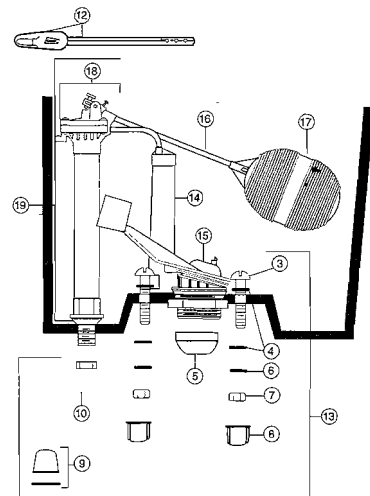

See the Index for a Description of Prefixes & Suffixes