

Parts list for fittings number: E-9030 E-9031 E-9035 E-9036 E-9040 E-9045 (All Disc. 1972)

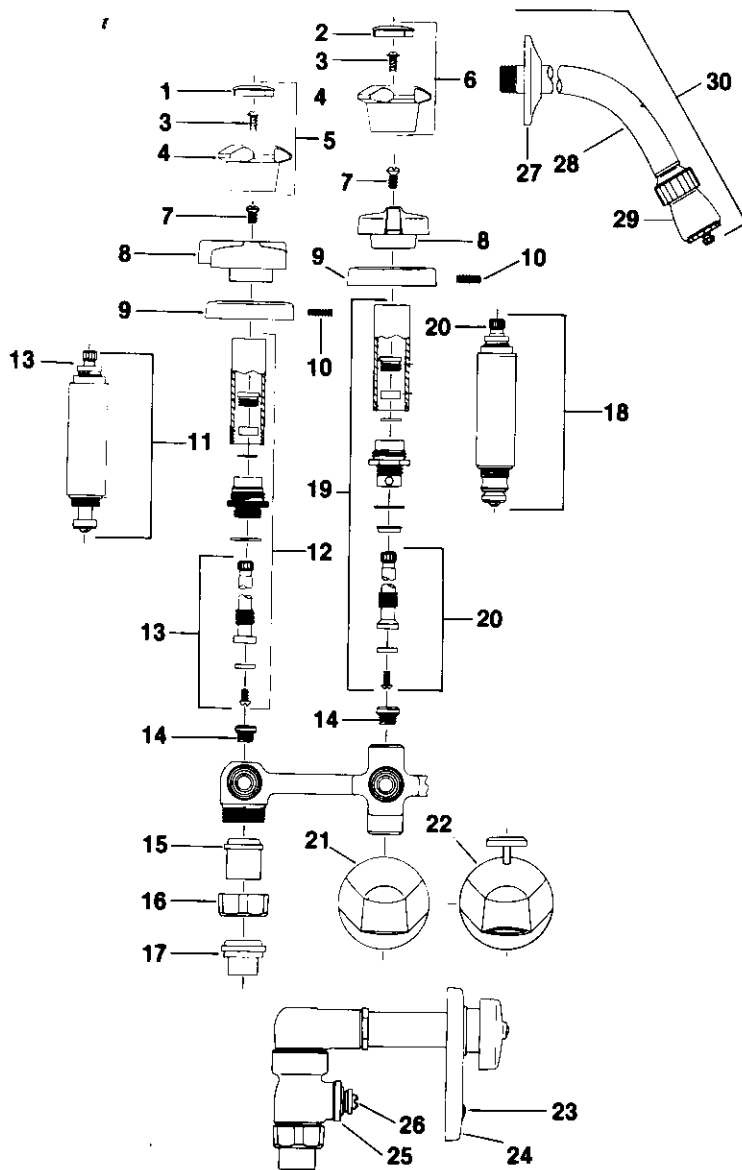
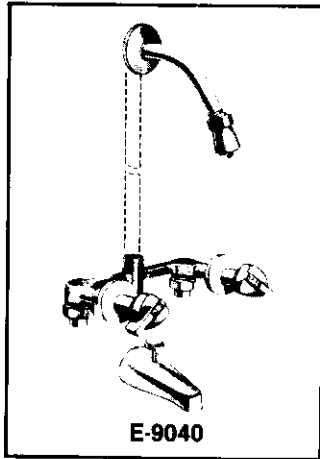

Item No.	Part No.	Description
+ *1A	490-6151-01	Button — Red dot (hot)
1B	490-6151-02	Button — Blue dot (cold)
2	490-6151-03	Button — Clear
3	490-2965-00	Screw
4A	490-6153-00	Translucent handle (plain)
4B	490-6153-03	Translucent handle (arrow)
+ *5A	490-6384-01	Trans. handle assy. (hot)
5B	490-6385-02	Trans. handle assy. (cold)
6	490-6386-03	Trans. handle assy. (arrow)
7	490-1978-00	Screw
+ *8A	490-5248-01	Handle ("H") C.P.
+ *8B	490-5248-02	Handle ("C") C.P.
+ *8C	490-5271-04	Handle (arrow)
*8D	490-6023-01	C.P. brass handle assy. w/escutcheon ("H") not shown
*8E	490-6023-02	C.P. brass handle assy. w/escutcheon ("C") not shown
*8F	490-6023-03	C.P. brass handle assy. w/escutcheon (arrow) not shown
+ *9A	490-5249-00	Flange
9B	490-6349-00	Escutcheon assy.
+ *10	490-5250-00	Set screw
+ *11A	490-5264-01	Stem unit L.H. (Type 1 C.P. cast brs.) (hot)
+ *11B	490-5264-02	Stem unit R.H. (Type 1 C.P. cast brs.) (cold)
12A	490-5264-01	Stem unit L.H. (Type 2 C.P. brs. tube) (hot)
12B	490-5264-02	Stem unit R.H. (Type 2 C.P. brs. tube) (cold)
13A	490-5268-01	Stem assy. L.H. (hot)
13B	490-5268-02	Stem assy. R.H. (cold)
14A	490-5257-00	Seat (brass)
14B	490-6464-00	Seat (plastic)
15	490-1757-00	Tailpiece (comb. IPS & sweat conn.)
16	490-1756-00	Coupling nut
17	490-2209-00	Tailpiece (sweat connection)
+ *18	490-5262-00	Diverter stem unit (Type 1 C.P. cast brs.)
19	490-5262-00	Diverter stem unit (Type 2 C.P. brs. tube)
20	490-5266-00	Diverter stem assy.
21A	490-5270-00	Spout, C.P. zinc
21B	490-4697-00	Spout, C.P. brass
22	490-4774-00	Diverter spout assy. (C.P. cast brs.)
23	490-3469-04	Index button, plain (used in 490-5711-00)
+ *24A	490-5711-00	Escutcheon, C.P. zinc
24B	490-6350-00	Flange assy.
25	490-5725-00	Stem unit
26	490-6713-00	Stem assy.
27	490-5354-00	Flange
+ *28	490-5345-00	Shower arm & ball assy.
+ *29	490-6651-00	Shower head assy.
+ *30	490-5343-00	Shower head, flange & arm assy.

For additional information on component parts of units and assemblies or identification of parts, see accessory section.

* = not available

+ * = not available, see note

Note: 1 — Item 1 specify Item 2. Item 5A available with clear button only (Item 2).

2 — Items, 8A, 8B, replace with two 490-6971-00 for hot & cold to provide matching handles. On three valve fittings replace Item 8C with 490-6971-04 (arrow).

3 — Items 9A & 10 specify Item 9B.

4 — Items 11A & 11B specify Item 12A or 12B as req'd.

5 — Item 18 specify Item 19.

6 — Item 24A specify 24B.

7 — Items 28, 29, 30 specify 490-6757-00 shower head, arm & ball assy.