

Parts No Longer Available

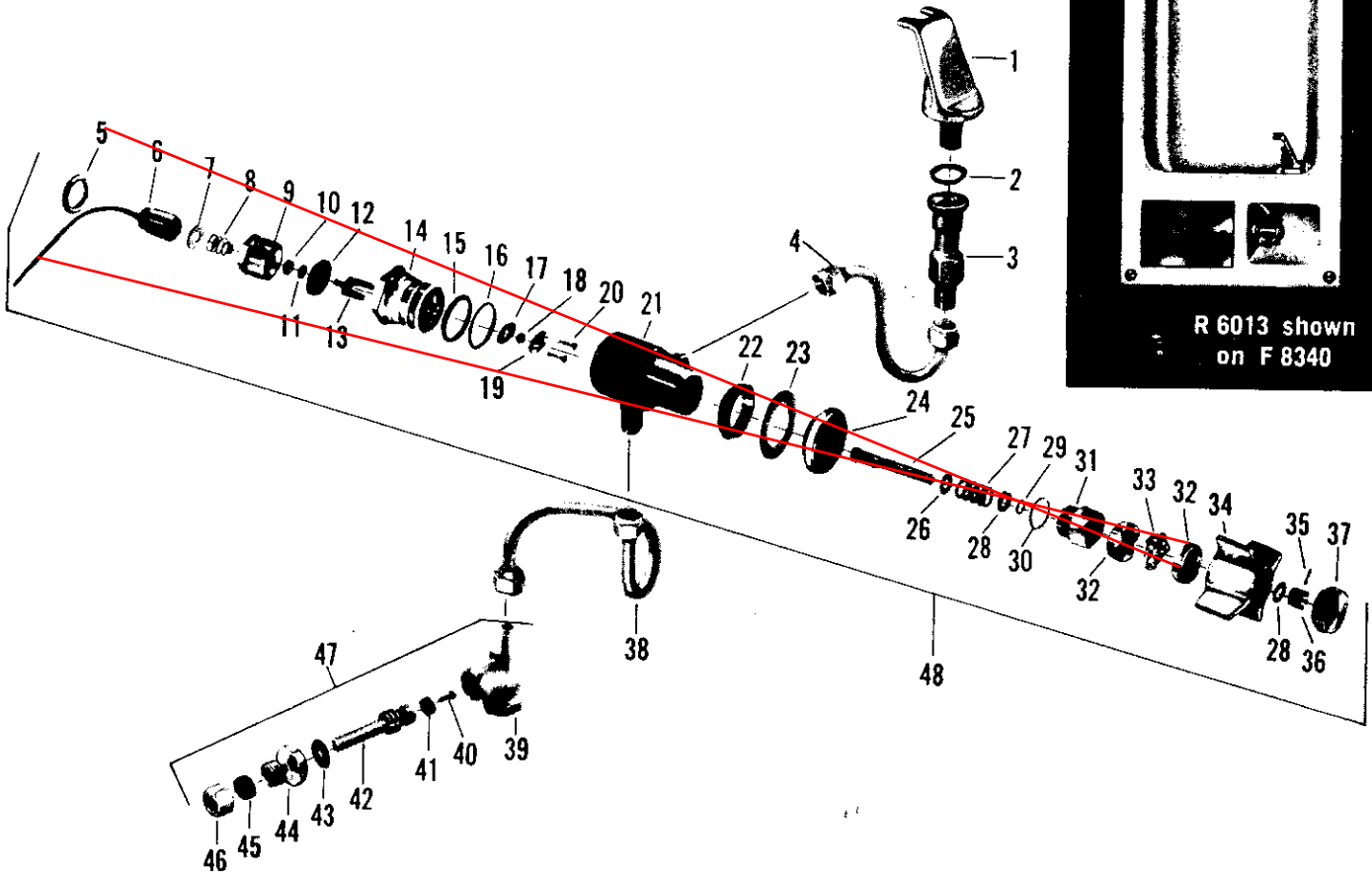

no.	description	part no.	R 6013	no.	description	part no.	R 6013
1	Bubbler w/washer	7454-02		25	Stem	1711-07	
2	Washer	28-17		26	Retaining Washer	113-17	
3	Socket	25680-08		27	Spring	1718-07	
4	Supply Tube to Bubbler	1756-07		28	Friction Washer	21771-08	
5	Lock Ring	187-27		29	"O" Ring	1617-07	
6	Leak Tube w/nut	7457-08		30	Static Seal	27-37	
7	Washer	968-27		31	Spring Housing	34-22	
8	Spring	1708-07		32	Cam	171-37	
9	Spring Chamber	1174-17		33	Ball Race	527-17	
10	Nut	1115-07		34	Handle	92-22	
11	Washer	94-27		35	Pin	433-07	
12	Diaphragm	152-27		36	Handle Nut	1150-07	
13	Yoke	1005-17		37	Handle Cap	1312-32	
14	Sleeve	1101-27		38	Supply Tube to Valve	1759-07	
15	"O" Ring	1719-07		39	Stop Body	34711-08	
16	Washer	9-27		40	Seat Washer Screw	159-17	
17	Seat Washer Holder	1441-37		41	Seat Washer	441-07	
18	Seat Washer	1398-27		42	Stem w/washer & Screw	19422-08	
19	Seat Washer Plate	1440-37		43	Cap Washer	125-07	
20	Screw	307-07		44	Stuffing Box Cap	21423-08	
21	Valve Body	25382-08		45	Packing	1311-07	
22	Lock Nut	25045-08		46	Stuffing Nut	25015-07	
23	Friction Washer	1013-29		47	Stop S/A	7479-08	
24	Escutcheon	1198-32		48	Self-closing Valve S/A	7488-02	

Note - Access Plate (not illustrated) - #760-29