

MODELS 4040, 4043, 4048

1. AS N3025: This ballcock has been replaced (see below for size)
2. AS N3055: Old style flush valve (no longer available)
Use AS 47088-0700 new style flush valve with trip lever and AS 47060-0700 tank to bowl kit
3. AS N3071: Tank lever (no longer available - use 73439-0200 - 6") See Note
4. AS N3073: Tank lever (no longer available)
5. AS N3075: Tank lever (no longer available)
(use AS 70437-0200 - 4" - plastic arm tank lever included in 47088-0700 flush valve) See Note

Note: The 70437-0200 and 73439-0200 will not work with the N3055. They will only work with the 47088-0700.

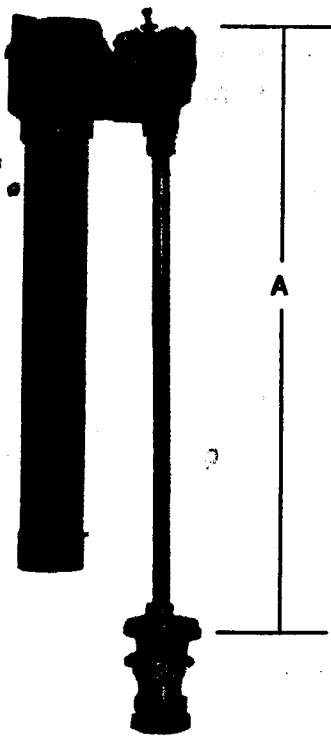
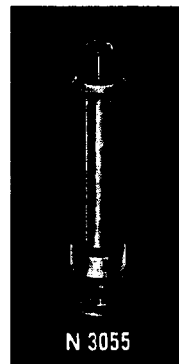

AMERICAN STANDARD GENUINE OBSOLETE BALLCOCKS

PART NUMBER	A (SIZE)
3131-075	Approx. 11 Inches
3137-098	Approx. 11 1/2 Inches
3137-155	Approx. 9 3/4 Inches
3138-058	Approx. 13 3/4 Inches

Above water controls include float rod and refill tube, 3/8" coupling nut inlet.

REPAIR PARTS FOR ABOVE NUMBERS	
12971-09	Kit: Includes Cap And Plunger, Seal, Nylon Seat
70422-07	Cap And Plunger Assembly
73070-07	Seal
73002-07	Nylon Seat
73019-09	Pivot Arm
73018-07	Pivot Pin
1601-07	Float Ball

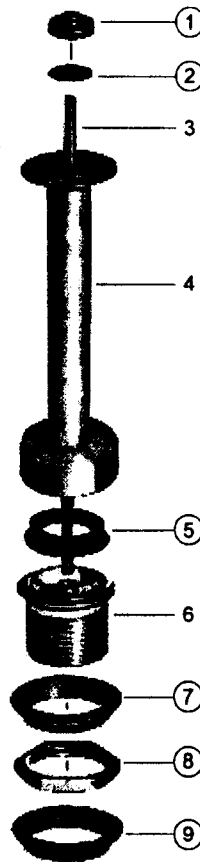

No.	DESCRIPTION	PART NUMBER
1	Grommet	73058-07
2	Stop	73059-07
3	Guide Tube - 11 9/16" Long	73054-07
	Guide Tube - 12 5/16" Long	73055-07
	Guide Tube - 13 3/16" Long	73056-07
	Guide Tube - 14 11/16" Long	73057-07
4	Float S/A - 9 1/32" Long	73060-07
	Float S/A - 9 25/32" Long	73061-07
	Float S/A - 10 21/32" Long	73062-07
	Float S/A - 12 5/32" Long	73063-07
5	Seal	73069-07
6	Body	73050-07
7	Washer	1039-07
8	Lock Nut	73217-07
9	Washer - Soft Washer	73216-07
	Washer - Hard Washer	1039-07

*Circled parts still available

ASSEMBLY-INSTRUCTIONS 120 for Part No. 47060-07

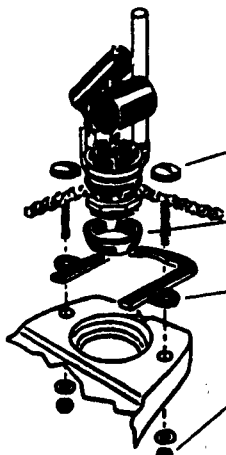

1. Place rubber washers under head of bolts and insert through holes in bottom of tank.
2. Place beveled sponge washer on threaded extension of flush valve so that the entire top surface of the washer is in contact with the bottom of the tank.
3. Place tank cushion over both ends of the bolts, carefully positioning so that it does not slip under the beveled washer.
4. Assemble tank to bowl and secure with metal washers and nuts.
5. Connect water control to supply line using enclosed washer and coupling nut.

TIGHTENING INSTRUCTIONS

Pull tank down evenly and level by alternately tightening nuts. A water tight rigid connection is assured when nuts are tight.



Flush Valve
3157.014
47088-07

Replaces N3055
(old style)



Plumbing Parts Depot

www.ppd1.biz